

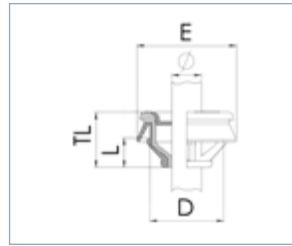

CLIXX membrane cable entries with strain relief



CLIXX



Protection class IP66 / IP67
Temperature range -40 °C - 65 °C
Material Polypropylene, Membrane TPE

Type	WISKA-No. RAL 7035 LG	WISKA-No. RAL 9001 WH	WISKA-No. RAL 3000 RD	WISKA-No. RAL 9005 BK	 D (mm)	 (mm)	 DD (mm)	 S (mm)	TL (mm)	
CLIXX 16	10101861	10101932	10101931	10101930	16	4,5 - 10	16,7	0,8 - 3,5	15	50
CLIXX 20	10101359	10101935	10101934	10101933	20	6 - 13	20,7	0,8 - 3,5	15	50
CLIXX 25	10101862	10101938	10101937	10101936	25	9 - 17	25,7	0,8 - 3,5	15	50

MultiCLIXX multiple membrane entry with strain relief, EMTZ

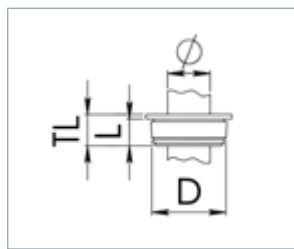

EMTZ



Protection class IP66
Glow wire test 960 °C
Temperature range -30 °C - 80 °C
Material Polypropylene, Membrane TPE

Type	WISKA-No.	 D (mm)	 L (mm)	 (mm)	TL (mm)	 DD (mm)	
EMTZ 32/02/120-02/080 V0	10108616	32	9,5	4 - 12	12	32,5	50